

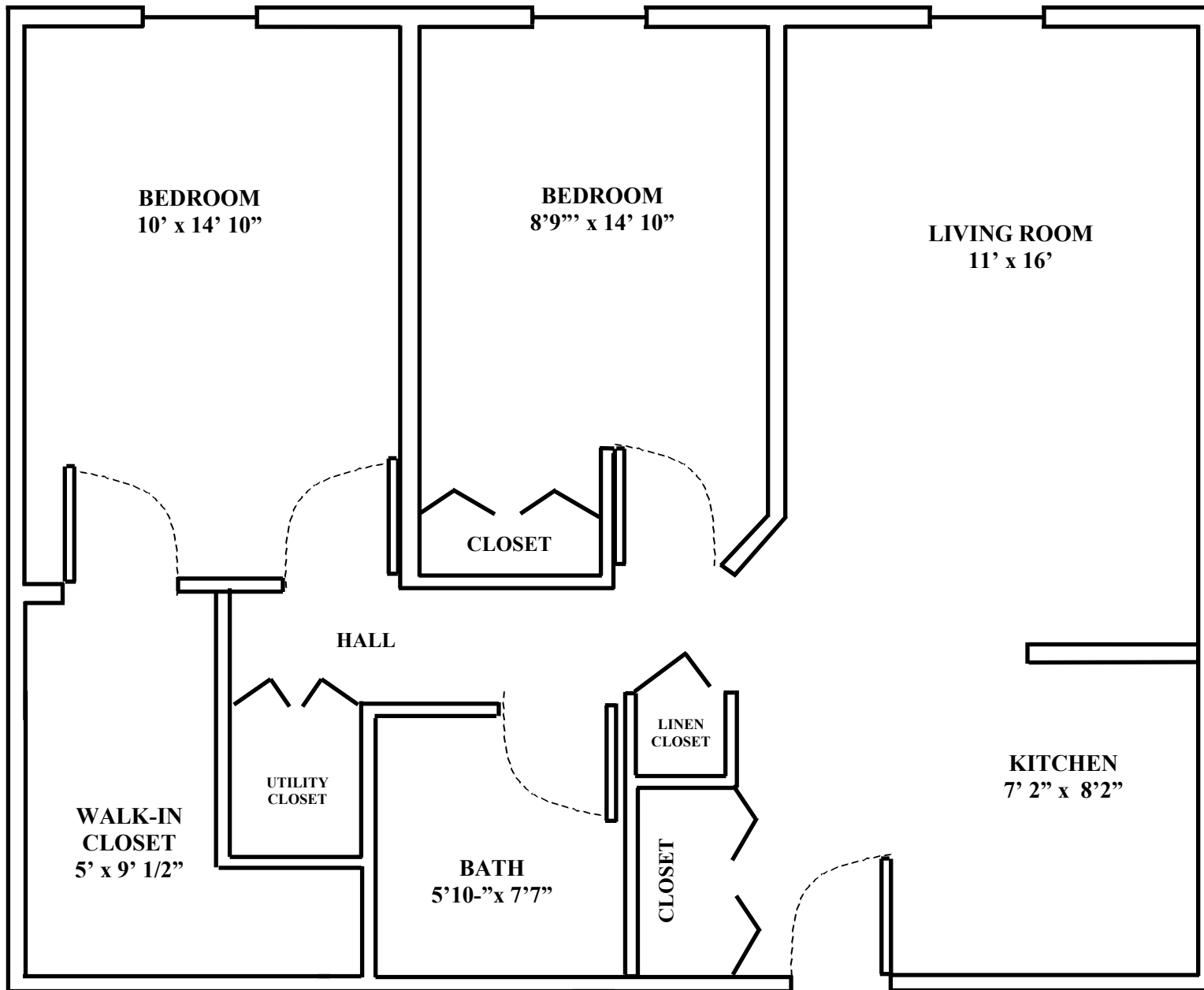







# GATEWAY MANOR FLOOR PLAN & PLANNING GUIDE

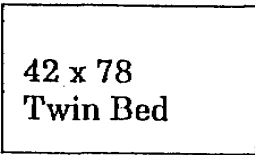

- Chair 
- Soft Chair 
- Stool 
- 21 x 30 Table 
- 21 X 42 Dresser 
- Night Stand 
- 42 x 78 Twin Bed 
- 36 x 72 Sofa 
- 14 x 36 Bookcase 

## SUITE TYPE B

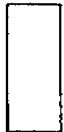
The outlines of the furniture depicted can be used to determine the placement of furniture. You can cut out or trace the outlines.  
SCALE = 1/4 INCH = 1 FOOT

# GATEWAY MANOR FLOOR PLAN & PLANNING GUIDE

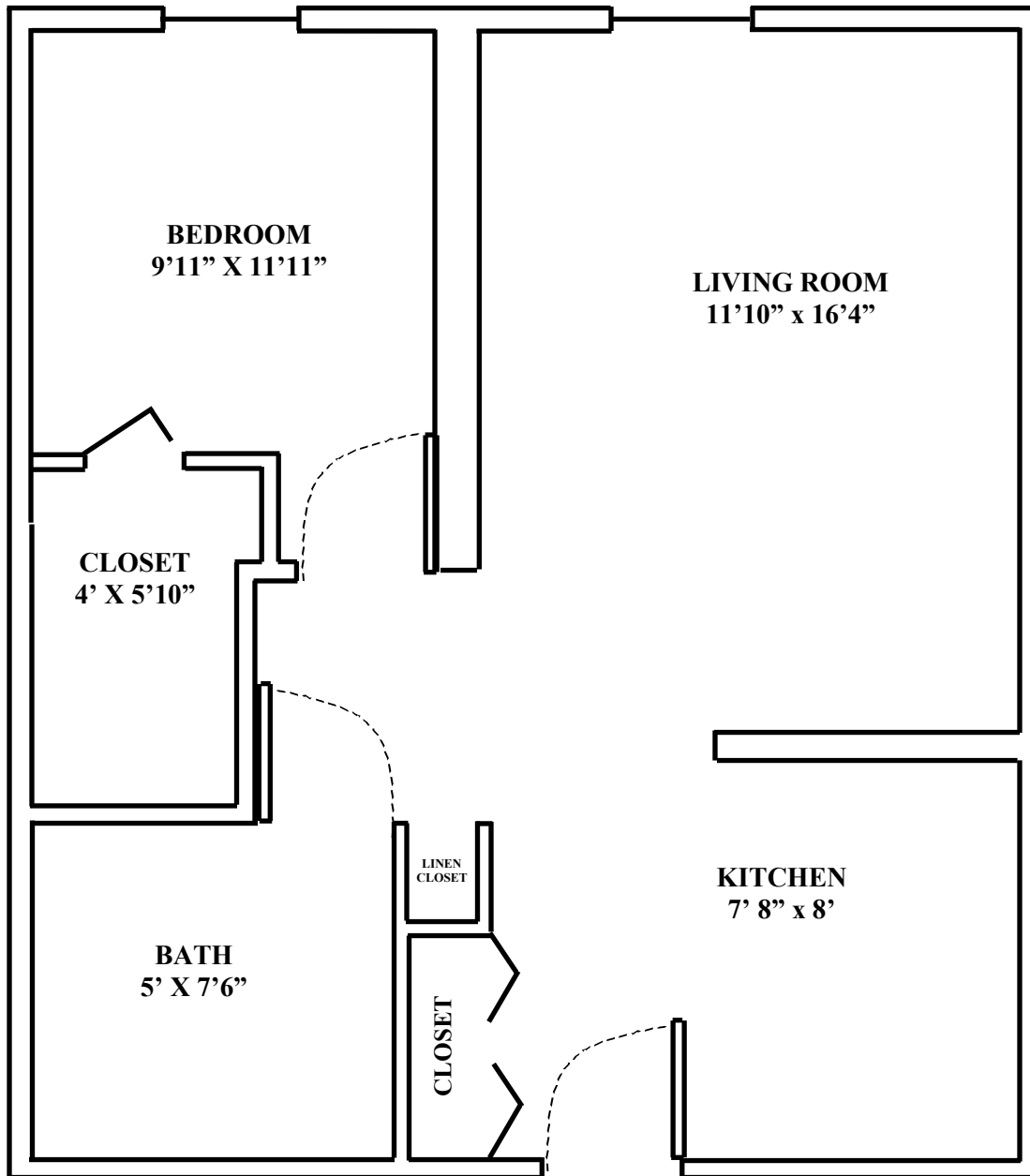

**SUITE TYPE A**

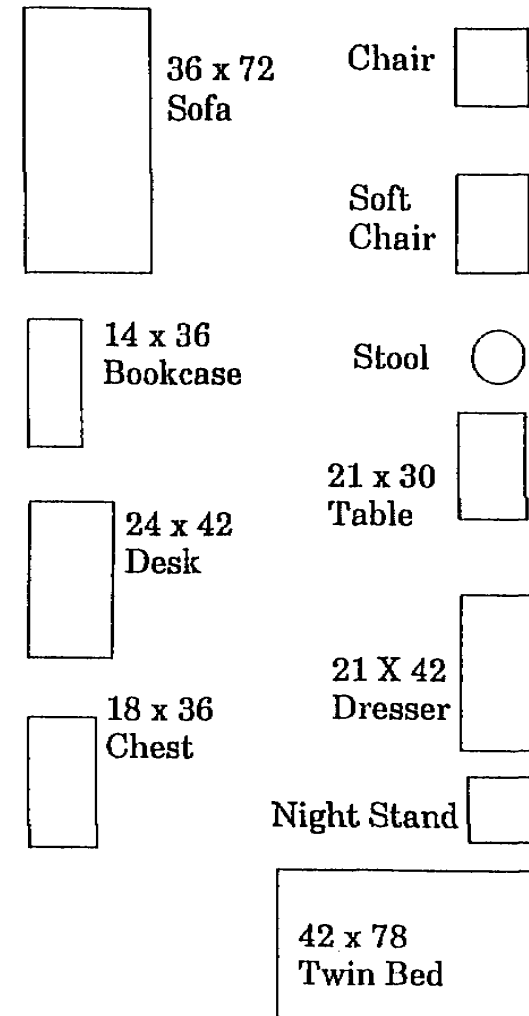







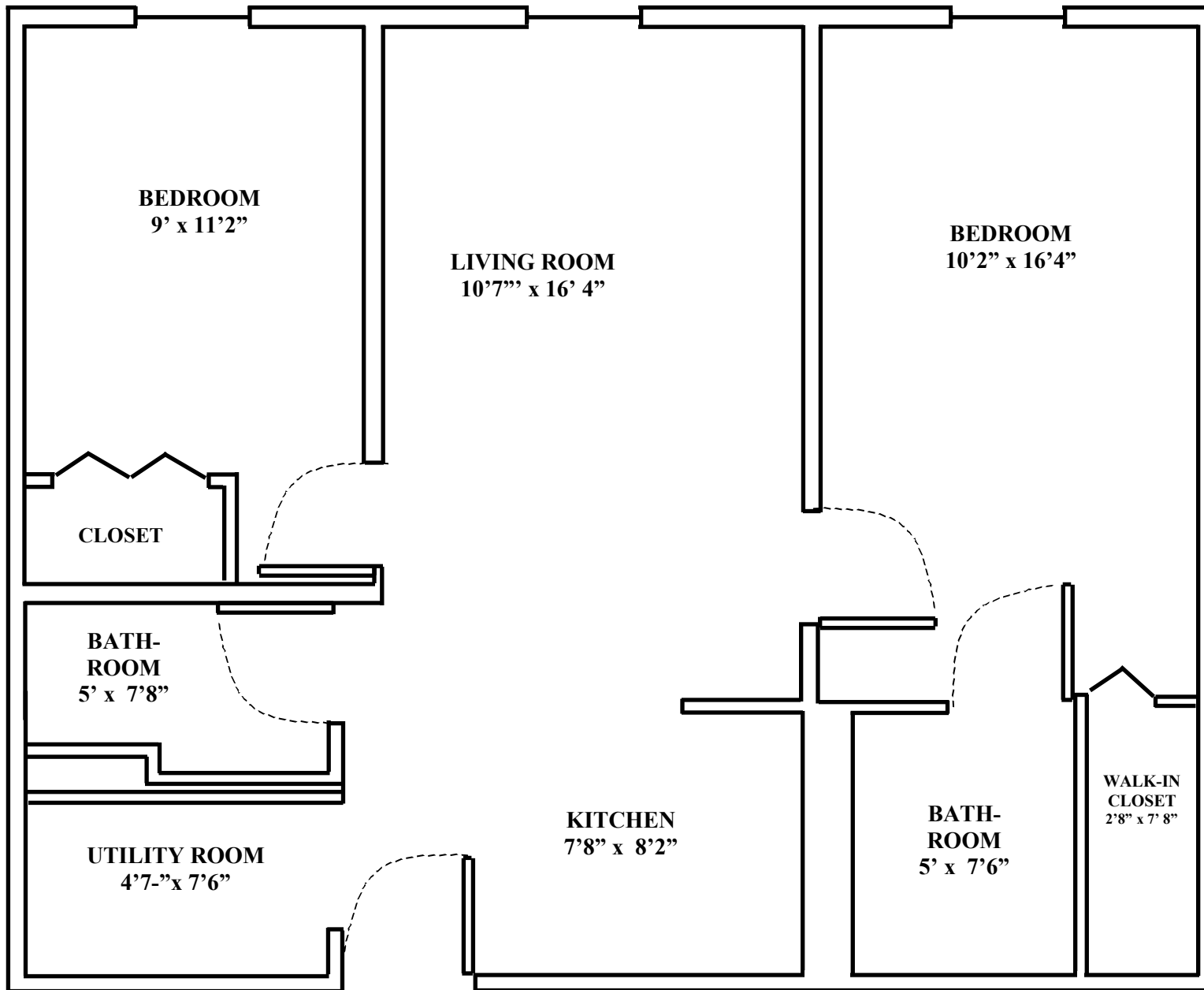

The outlines of the furniture depicted can be used to determine the placement of furniture. You can cut out or trace the outlines.

SCALE = 1/4 INCH = 1 FOOT

# GATEWAY MANOR FLOOR PLAN & PLANNING GUIDE

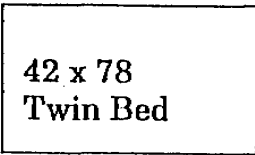

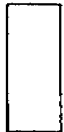
- Chair 
- Soft Chair 
- Stool 
- 21 x 30 Table 
- 21 X 42 Dresser 
- Night Stand 
- 42 x 78 Twin Bed 
- 36 x 72 Sofa 
- 14 x 36 Bookcase 

**SUITE TYPE C**

The outlines of the furniture depicted can be used to determine the placement of furniture. You can cut out or trace the outlines.  
 SCALE = 1/4 INCH = 1 FOOT